

Products specifications

Unlock method	Password unlock, app unlock
Password combination	1-9 Digital key button
Password length	A 6-digit password
Number of Password	200 pcs
Battery type	CR2032
Battery life	12months
Product material	Zinc alloy
Product size	76*46*22 mm
Waterproof ability	IP67
Working temperature	-20 ~ 55℃

Dear users,

Thank you for choosing a smart Password padlock. In order for you to have a better use experience, please read the instructions carefully before experiencing the product. When you get the product, pull off the plastic film on the back of the product and power the product to work.

The factory default password of this product is ①②③④⑤⑥, Enter the password will automatically unlock the lock .

Blue light comes on after pressing the number. If the password is incorrect , the red light will light up for one second ; If the password is correct, the green light will light up for one second and unlock .

Intelligent use

1. Download Tuya Inc.



Download website



2. Connect Bluetooth

Press the random number for about 3 seconds, and the blue light is on.

①Open the app, click "+" in the upper right corner, and then click "Add Device".

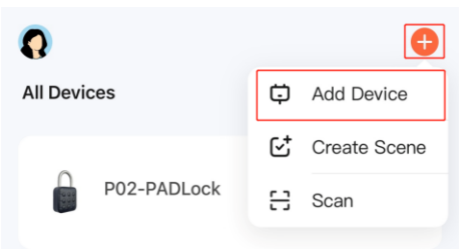

②Click "Add" to connect the device.

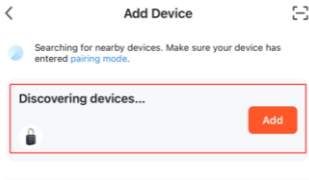

③Click "Done" after adding P02-PADLock.

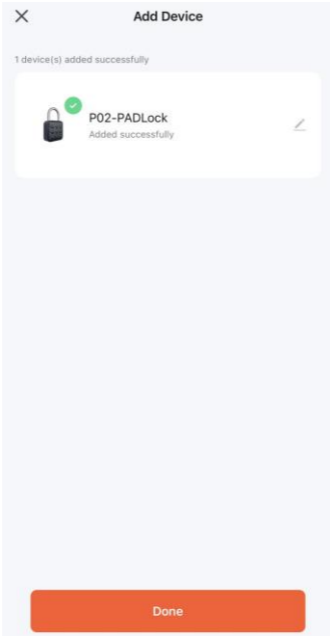

3. Bluetooth unlock

Slide the lock sign from left to right to unlock the lock.

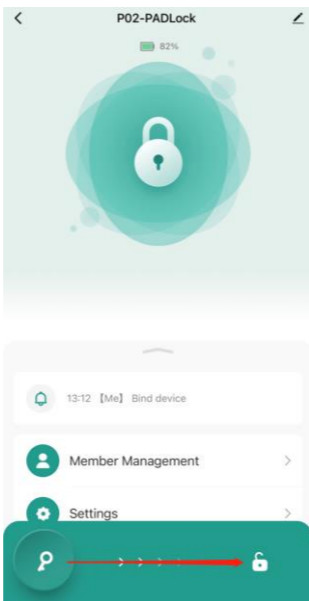

4. Add users

①Click on the "Member Management".

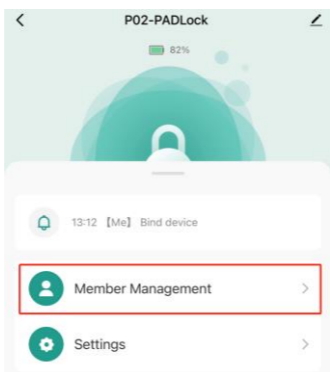

②Click "me" to enter the add interface.

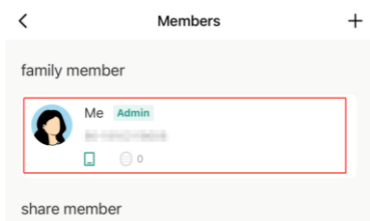

③Click "Add" to add more users.

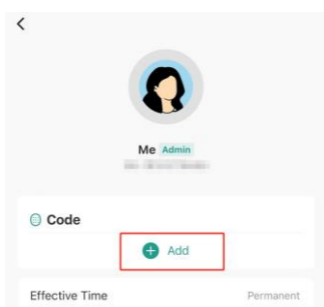

④Add a password, set a 6-digit password and click "Save", then the user is added successfully.

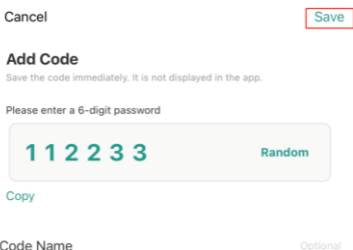

5. Delete the users

①Click on the user name that you want to delete.

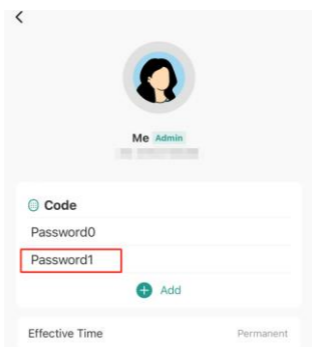

②Click on the Delete Code.

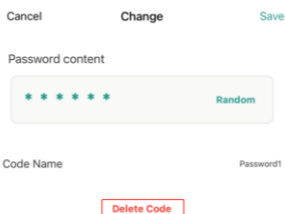

③Click on OK.

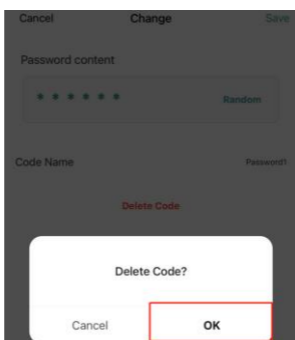

④The list was successfully deleted successfully .

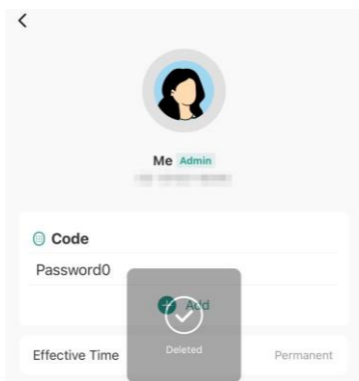

(When the device is connected to Bluetooth, if the user deletes them all, the device will resume the factory setting!)

Abnormal treatment method

When there is any abnormality in the product, please try to open the lock several times. If not, please replace the new button battery before trying to open the lock.

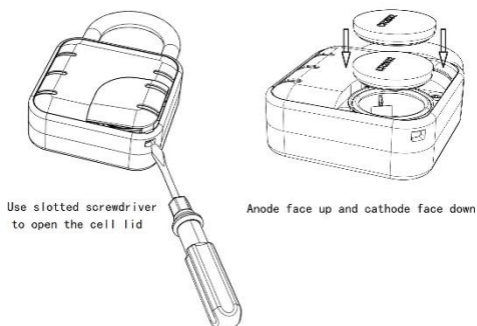

Factory data reset

Operation mode : long press the number key "9" to keep the blue light for about 6 seconds , flashing the red light , entering the password at the same time , keep flashing the red light and operating again ; if the password is entered correctly , the light is changed by green-yellow-green , the password is cleared , and the equipment shall restore the factory setting .